

REGIONE PIEMONTE
COMUNE DI BELLINZAGO NOVARESE

P.R.G.

Tavola 4.16
Badia di Dulzago
Rapporto 1/2000

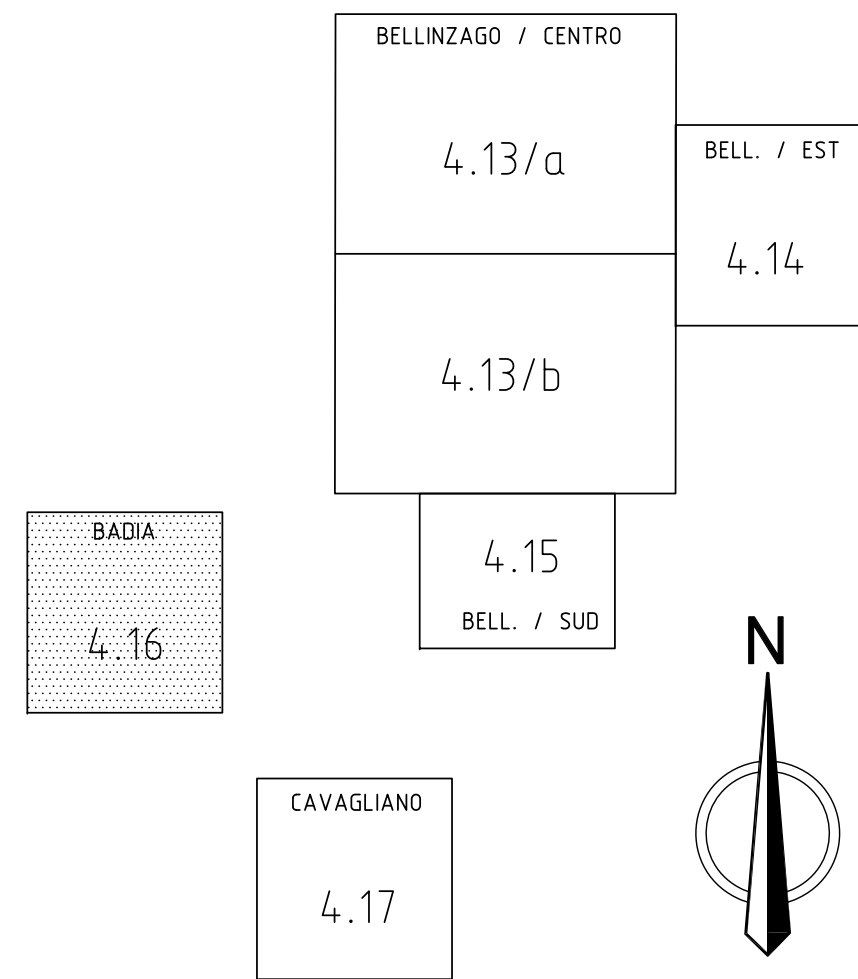

Adozione Delib. C.C. n. 49 del 29-07-1997
Controded. Oss.ni Delib. C.C. n. 18 del 08-05-1998
Approvazione Del. G.R. n 6-1226 del 06-11-2000

IL TECNICO IL SINDACO IL SEGRETARIO

Aggiornamento 30.05.1997 CON MODIFICHE D'UFFICIO

LEGENDA

STANDARD

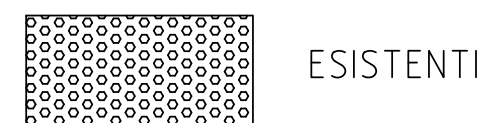

ESISTENTI



DA ACQUISIRE

ZONE OMOGENEE

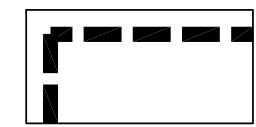

A

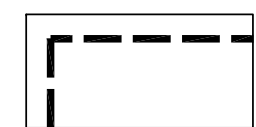

D1 - D2

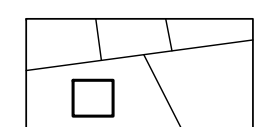

E

VINCOLI

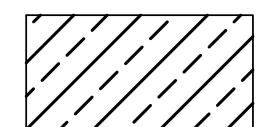

PAESAGGISTICO

